

## SERIE POWER

Contropunta ad alta precisione con ghiera di estrazione  
 High precision live center with ring nut

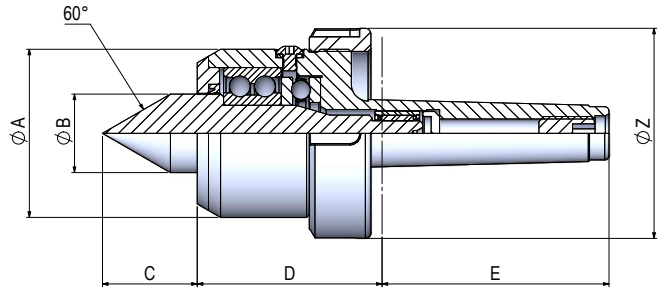

### CARATTERISTICHE GENERALI / Technical data

CONO MORSE / Morse Taper	PESO / Weight (kg)	CARICO / Load		ECCENTRICITA' / Eccentricity	MAX GIRI / 1' / Max Rounds / 1' r.p.m.
		ASSIALE Axial (N)	RADIALE Radial (N)		
C.M.3	1,1	3040	970	0,003 / 0,005	4500
C.M.4	1,9	3730	1730	0,003 / 0,005	4000
C.M.5	3,9	5100	2530	0,003 / 0,005	2800
C.M.6	9,1	6680	4570	0,003 / 0,010	2400

### SERIE POWER con cuspidi standard / SERIES POWER with standard point

CONO MORSE / Morse Taper	DIMENSIONI / Dimensions (mm)						SERIE / Series	CODICE / Code
	$\phi A$	$\phi B$	C	D	E	Z		
C.M.3	60	28	34	66	81	75	POWER/3	RPW003.000.01
C.M.4	70	35	69,5	69,5	102,5	82	POWER/4	RPW004.000.01
C.M.5	90	40	50	76,5	129,5	105	POWER/5	RPW005.000.01
C.M.6	Sostituito con POWER 6 P - RPW006.000.07 - Pagina 14							

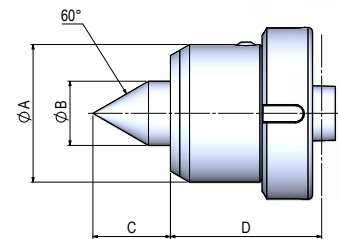

### SERIE POWER T / SERIES POWER T

CONO MORSE / Morse Taper	DIMENSIONI / Dimensions (mm)					SERIE / Series	CODICE / Code
	$\phi A$	$\phi B$	$\phi B1$	C	D		
C.M.3	60	28	6	41,5	66	POWER/T3	RPW003.000.02
C.M.4	70	35	9	51	69,5	POWER/T4	RPW004.000.02
C.M.5	90	40	12	56,5	76,5	POWER/T5	RPW005.000.02
C.M.5	130	65	20	86,14	102,5	POWER/T6	RPW006.000.17

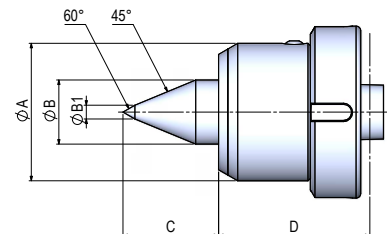

# SERIE POWER

Contropunta ad alta precisione con ghiera di estrazione  
 High precision live center with ring nut

## RICAMBI E ACCESSORI/ Spare parts and extra items

### FLANGE PER CONTROPUNTA / Flange for live center

SERIE / Series	DIMENSIONI / Dimensions (mm)				CODICE / Code
	øA	øB	øC	D	
FPI/45/98	45	98	35	55	RPW000.001.05
FPI/95/148	95	148	35	55	RPW000.002.05
FPI/145/198	145	198	35	55	RPW000.003.05
FPI/195/248	195	248	35	55	RPW000.004.05
FPI/245/298	245	298	35	55	RPW000.005.05

øB a richiesta fino a ø1000 /  
 øB on request till ø1000

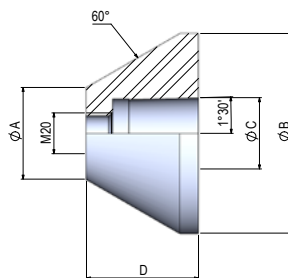

### GHIERA DI ESTRAZIONE PER SERIE POWER / SP-G / MA Ring nut for SERIES POWER / SP-G / MA

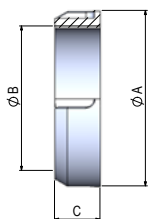

CONO MORSE / Morse Taper	DIMENSIONI / Dimensions (mm)			SERIE / Series	CODICE / Code
	øA	øB	C		
3	75	60x1,5	22	GHP 60	RPW003.005.00
4	82	70x1,5	22	GHP 70	RPW004.005.00
5	105	90x1,5	20	GHP 90	RPW005.005.00
6	140	110x1,5	23	GHP 110	RPW006.005.00

### Grafico carico assiale POWER SERIES POWER assial graph

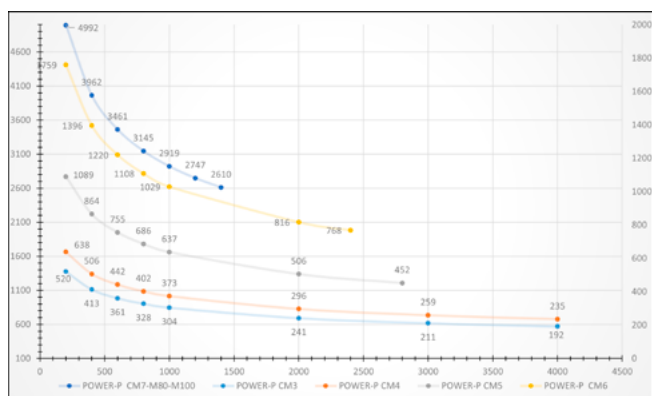

### Grafico carico radiale POWER SERIES POWER radial graph

